

ICM-12

Chassis TFT-Monitor 12,1"



overview:

- TFT / LCD monitor chassis
- screen diagonal 12,1"
- Interface RGB analog / DVI
- optional HDMI / DP
- mounting via VESA 75
- longterm availability
- customizations possible

Description:

The ICM-12 chassis monitors are specifically designed for use in industrial environments. The monitors can be mounted on support arms or similar fixtures using a VESA mount. With a stand, they can also be used as desktop monitors. The robust housing allows for operation even in the harshest environments, including 24-hour continuous use. The standard models come with an external wide-range power supply and feature both an analog VGA input and a DVI input.

technical data:

overview:

12,1" industrial TFT / LCD monitor chassis for support arms or desktop monitor

Resolution:

max. 800x600

Brightness:

min. 250cd/qm

Contrast:

600:1

Interface:

VGA DVI, optional HDMI / DP

Adjustments:

via On Screen Menü

MTBF:

Backlights min. 35000h

controls:

Touchscreen (Option)

power supply

12 VDC via external Power adapter

mechanical dimensions:

case: about 303 x 239 x 56mm

material:

case: steel

environmental conditions:

operating: 0-50°C

storage 0-65°C

humidity: 10 - 80 % rel. humidity

not condensing

norms:

EMV: EN55022 EN55024 EN61010-1

part number:

10050602	ICM-12-12,1" Chassis-Monitor
10050522	Option protected glass ICM-12
10050504	Option Touchscreen 12,1"
10050519	Option HDMI / Displayport
10050535	Option High brightness

ICM-12

Chassis TFT-Monitor 12,1"

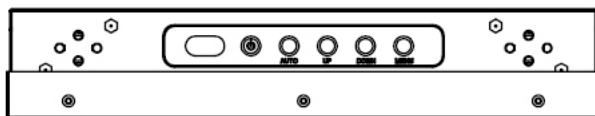
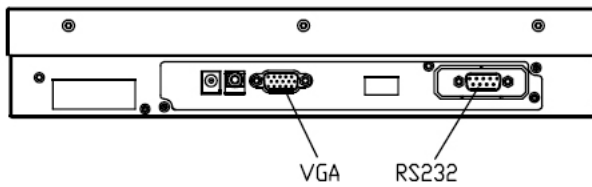
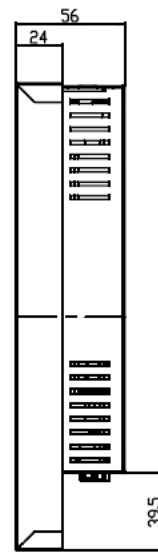
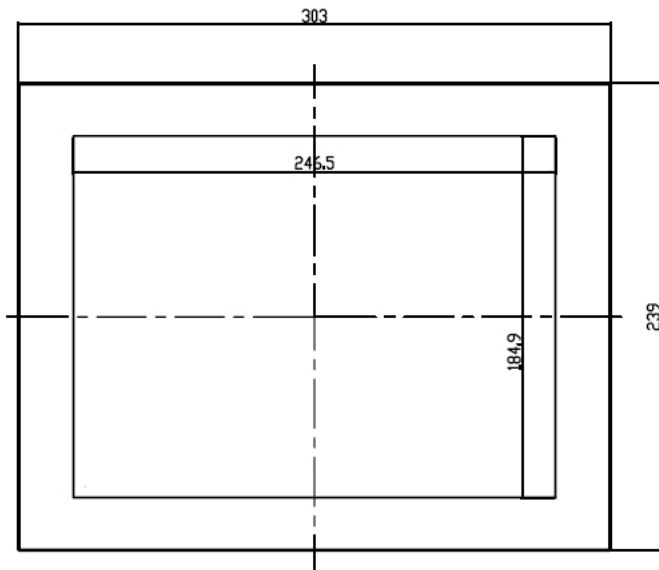

TOP VIEW

